

SUBDIVISION MAP NO.156

WILDFLOWER SUBDIVISION, UNIT 3

BEING UNIT 3 OF WILDFLOWER SUBDIVISION, LARGE LOT FINAL MAP
PER BOOK 9 SUBDIVISION PAGE 1

FILED THE 6TH OF OCTOBER 2006 RECORD OF AMADOR COUNTY
LYING WITHIN A PORTION OF THE WEST 1/2 OF SECTION

30, T.6 N., R.10 E., M.D.M.

CITY OF IONE

COUNTY OF AMADOR, CALIFORNIA
KASL CONSULTING ENGINEERS, INC.

JUNE 2020

SHEET 6 OF 7

CITY OF IONE
2006-0013529

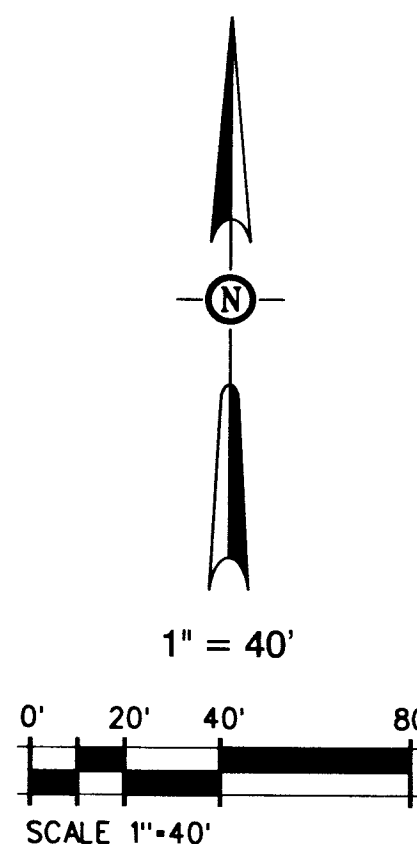

LEGEND

- FOUND MONUMENT AS DESCRIBED
- ✕ FOUND 1" IRON PIPE WITH PLUG STAMPED "RCE 26388" PER 9 S 89
- SEARCHED & NOTHING FOUND, SET 1" IRON PIPE WITH TAG "RCE 26388"
- SEARCHED & NOTHING FOUND, SET 5/8" REBAR WITH PLASTIC CAP "RCE 26388"
- SET BRASS CAP IN CONCRETE MONUMENT BOX STAMPED "RCE 26388"
- COMPUTED POINT, NOTHING SET

— BOUNDARY LINE OF SUBDIVISION

----- LIMITS OF SUBDIVISION STREETS
OUTSIDE OF WILDFLOWER UNIT 3

P.U.E. PUBLIC UTILITY EASEMENT

P.F.E. PUBLIC FACILITY EASEMENT

P.S.E. PRIVATE STORM DRAIN EASEMENT
(BENEFITS AS NOTED)

(M) MEASURED

N.A.P.O.T.S. NOT A PART OF THIS SUBDIVISION

(R1) WILDFLOWER SUBDIVISION
9-SUBDIVISIONS-1
REC 10/6/2006

(R) RECORD DATA

NOTE: ALL DISTANCES ARE IN FEET AND
DECIMALS THEREOF

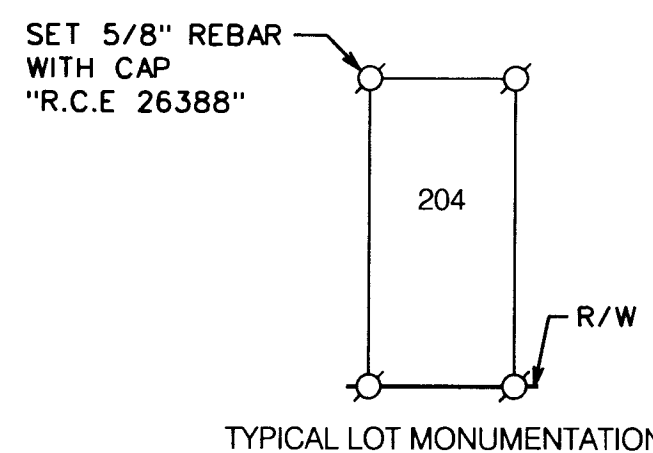

RADIAL BEARING TABLE

- ① S32° 47' 20" W
 - ② S47° 56' 46" E
 - ③ S57° 12' 40" E
 - ④ N42° 03' 14" E
- THIS SHEET ONLY

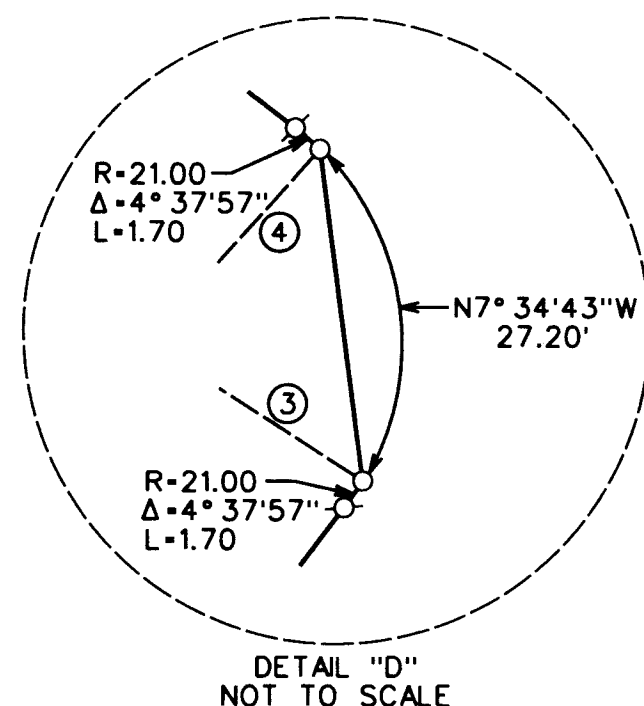
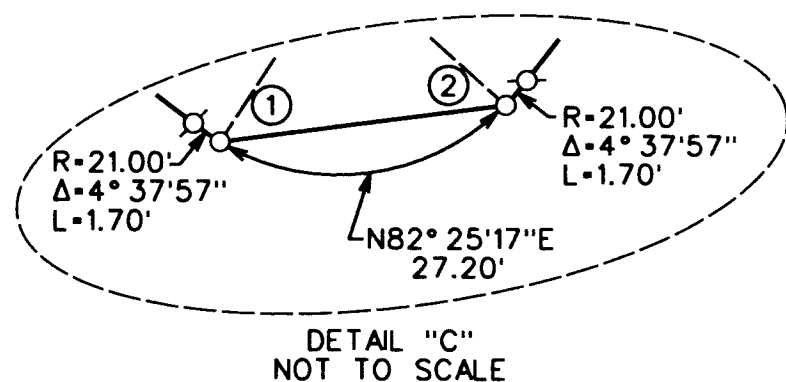

BASIS OF BEARINGS

SEE SHEET THREE FOR BASIS OF BEARINGS

UNIT 4
WILDFLOWER
SUBDIVISION
9 SUB 1
N.A.P.O.T.S.

