

SET 2 1/2" DIA. "CADT" BRASS CAP IN  
A 1 1/4" O.D. X 30" GALV. PIPE, WITH  
CONCRETE, UP 0.6', STAMPED  
IN CENTER OF EXISTING  
ROCK MOUND. WIRED  
SCRIBED STONE ON  
W'LY SIDE OF PIPE.

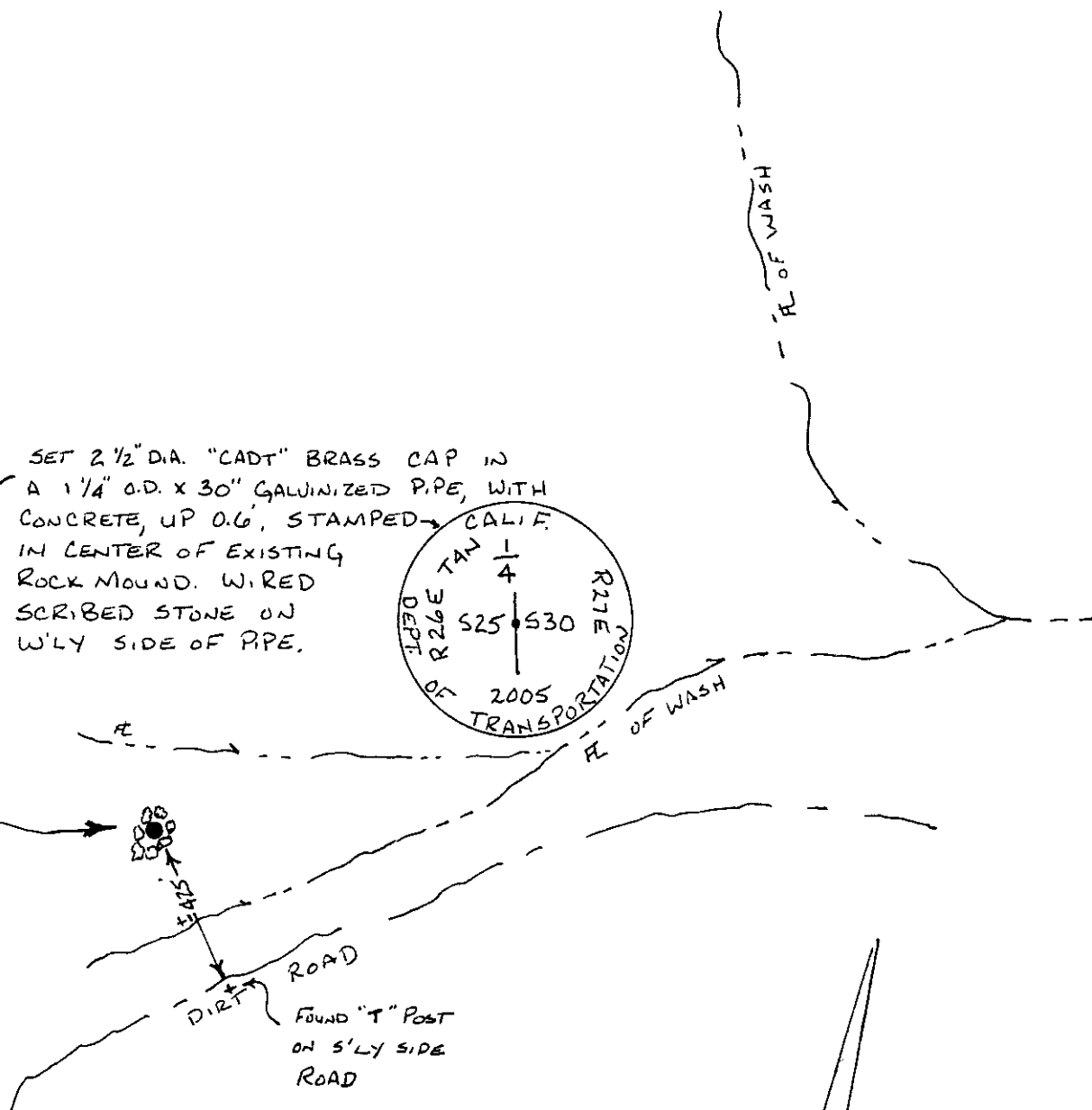
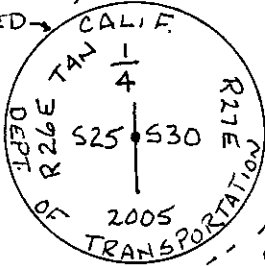

NOT TO SCALE