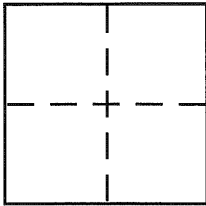

CORNER RECORDDocument Number CR 2118
City of Berkeley County of Alameda, California

Brief Legal Description _____

**CORNER TYPE**

Government Corner ☐ Control ☐
 Meander ☐ Property ☐
 Rancho ☐ Other ☒
 Date of Survey November 10, 2003

COORDINATES (Optional)

N. _____
 E. _____
 Zone _____ NAD27 ☐ NAD83 ☐
 NAD83 Epoch _____
 Elev. _____
 Vert. Datum: NGVD29 ☐ NAVD88 ☐
 Meas. Units: Metric ☐ Imperial ☐

Corner – Left as found ☒ Found and tagged ☐ Established ☐ Reestablished ☐ Rebuilt ☐

Identification and type of corner found: Evidence used to identify or procedure used to establish or reestablish the corner:

Found 3/8" brass pin in standard city monument well. City of Berkeley reference number B1516

The monument was referenced by straight lines through the monument
with distances shown on the diagram.

A description of the physical condition of the monument as found and as set or reset: Good condition

SURVEYOR'S STATEMENT

This Corner Record was prepared by me or under my direction in conformance with

the Land Surveyor's Act on November 10, 2003

Signed [Signature] P.L.S. or R.C.E. No. 5003

COUNTY SURVEYOR'S STATEMENT

This Corner Record was received 2-6-04

and examined and filed 3-29-04

Signed [Signature] P.L.S. or R.C.E. No. 5726

Title County Surveyor

County Surveyor's Comment _____



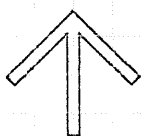
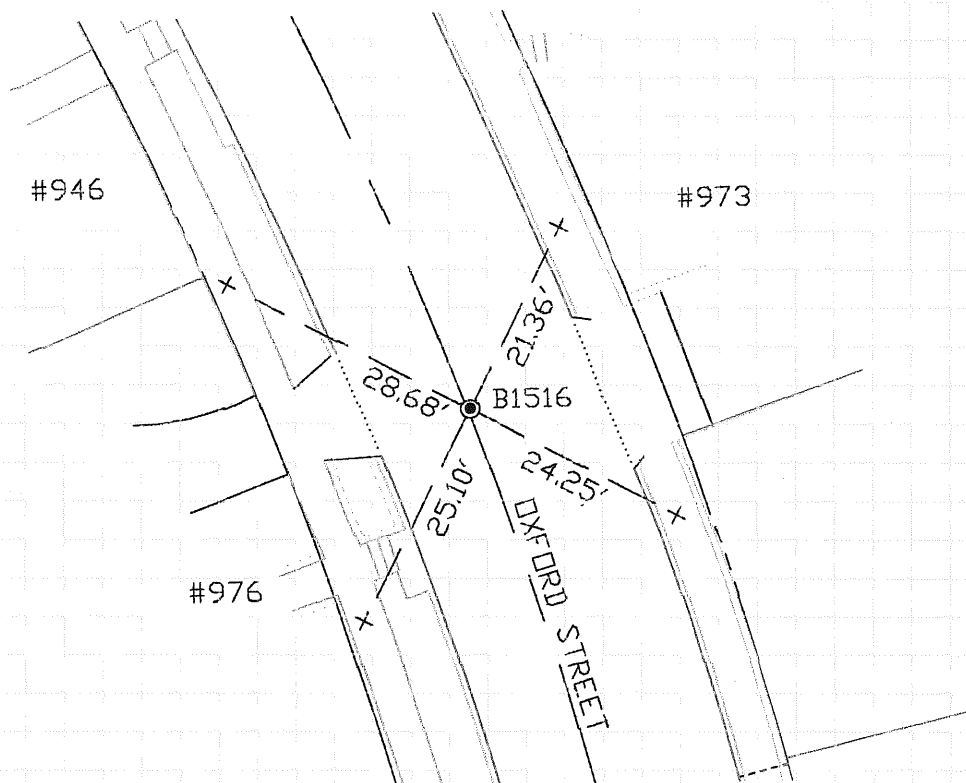

NORTH

Scale 1" = 20'

LEGEND:

----- BOUNDARY LINE

- - - - - CENTERLINE

===== CURB LINE

#912 HOUSE ADDRESS NUMBER

● FOUND 3/8" BRASS PIN IN
STANDARD CITY MONUMENT
WELL, CITY OF BERKELEY
REFERENCE NUMBER B1516

x SET CUT CROSS IN CONCRETE