

Swamp & Overflowed Lands  
State of California  
Stanislaus County

Survey No. 1

Township 3 South Range 12 East of the  
Base and Meridian of Mount Diablo

Sec 34 North Half of South East 1/4  
80 acres

Field notes of the above Survey made  
on the 6<sup>th</sup> day of Nov 1855

Surveyed for Jacob Harvey Gardenhire By Silas Wilcox County Surveyor

Beginning 20 chs North of the stake at the  
South East corner of Sec 34 thence running  
North 20 chs thence West 40 chs to a stake  
thence South 20 chs to a stake thence East  
40 chs to the place of Beginning  
containing 80 acres of land and being  
the North half of the South East quarter  
of Sec 34 T. 3. S. Range 12 East

Surveyed by the true Meridian  
with a magnetic variation of 15 34 East  
according to the U. S. Survey

and the same

Nov 6<sup>th</sup> 1855Plat No. 1

Jacob Harrey Gardenhire's overflowed land

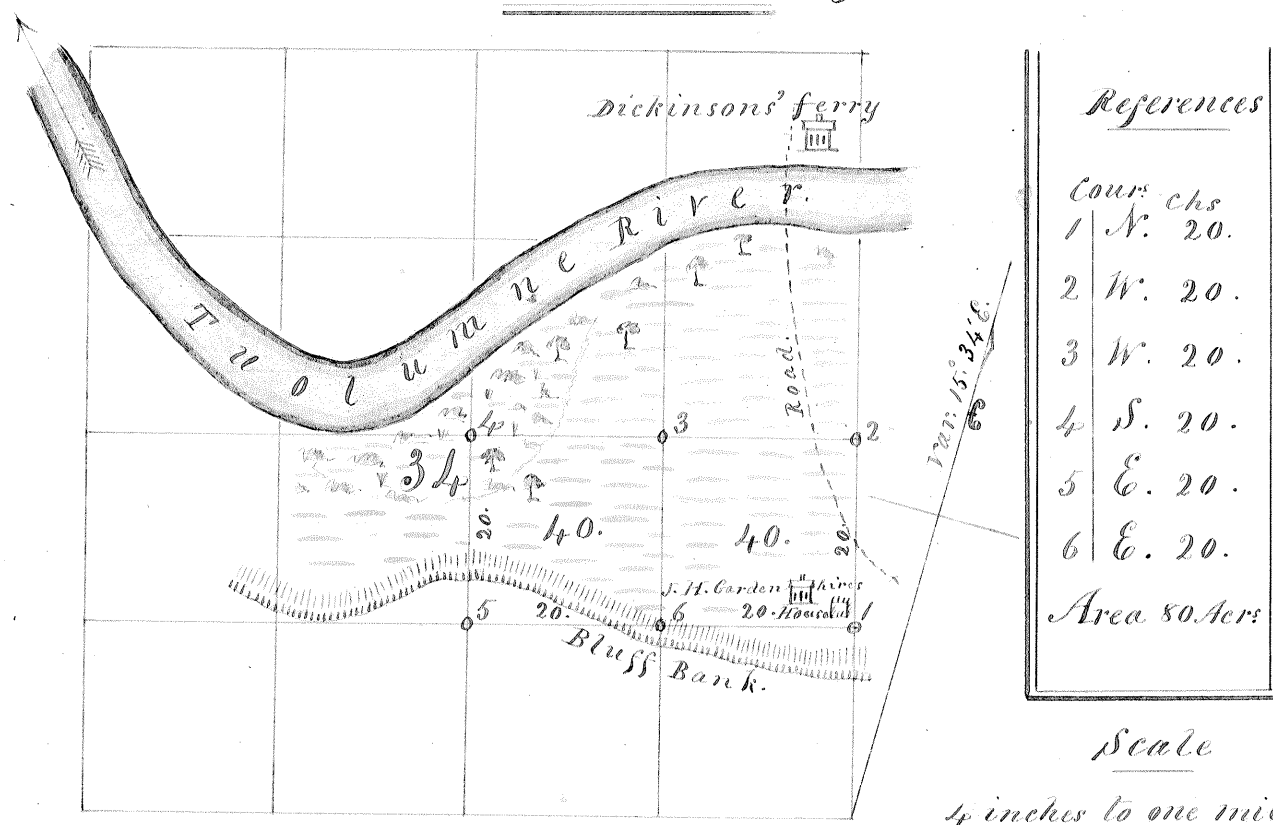
Section 34Township 3 South Range 12 EastStanislaus CountyReferences

Cours	chs
1	N. 20.
2	W. 20.
3	W. 20.
4	S. 20.
5	E. 20.
6	E. 20.

Area 80 Acres

Scale

1/4 inches to one mile

I hereby certify the foregoing Plat and field notes to have been made in

I hereby certify that I made the above Survey in accordance with the act of the Legislature and with the instructions of the Surveyor General of this State of California

Silas Wilcox  
County Surveyor