

County Surveyors Office, Stanislaus County, California.
Swamp and Overflowed Lands.

Survey No. 117. Correction of Survey No. 5.
Township 3 1/2 South.

Range 10 East.

Sections 32, 5 & 6. All between the U.S. Meander line and the left bank of the Tuolumne River in the South West 1/4 of Section 32, Township 3 South; & the West 1/2 of the East 1/2 & the West 1/2 of Section 5 & the East 1/2 of the West 1/2 and the East 1/2 of Section 6, Township 3 South.

Base and Meridian of Mount Diablo.

Containing 109.09 Acres.

Surveyed July 28th 1859 for

Eli S. Marvin.

Field Notes.

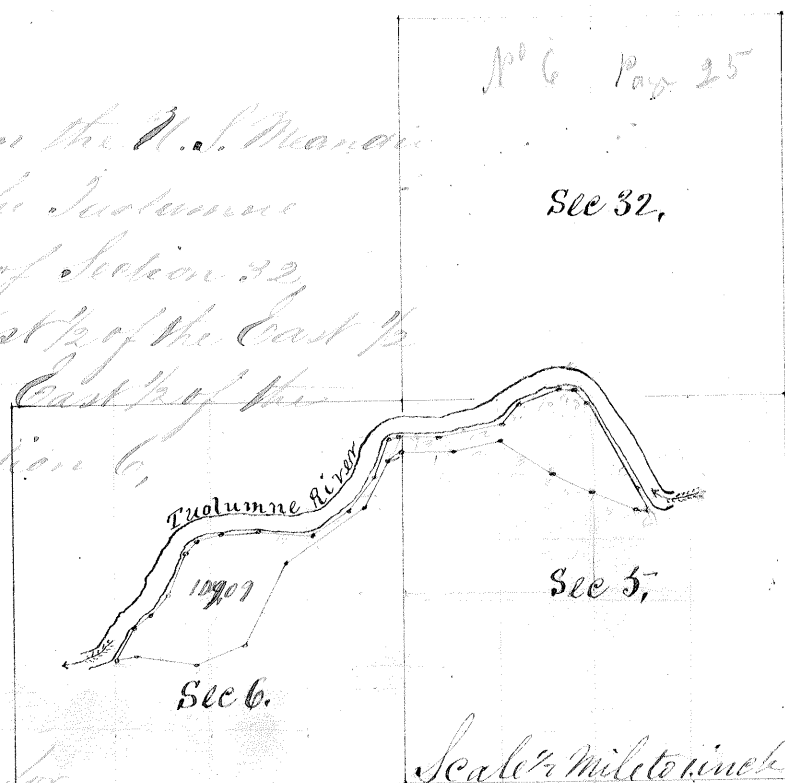

Beginning at Meander Post on line between Sections 5 & 6. Thence run on U.S. Meander line N 87 1/2° E 10.50 ch, N 77 1/2° E 10.00 ch, S 59° E 13.00 ch, S 66° E 9.00 ch, S 68° E 10.00 ch, S 66 1/2° E 2.11 ch to the left bank of the Tuolumne River. Meander down stream. Run N 28 1/4° W 25.73 ch, N 32 1/4° W 3.76 ch, N 87 1/2° W 3.00 ch, S 69 1/4° W 9.59 ch, S 43° W 5.45 ch, S 20 1/4° W 13.57 ch, N 88 1/2° W 7.20 ch, S 55° W 2.21 ch, S 19° W 7.34 ch, S 44 1/2° W 9.22 ch, S 57° W 8.72 ch, N 88° W 11.29 ch, S 83 1/4° W 7.60 ch, S 71° W 3.05 ch, S 48° W 3.42 ch, S 26 1/2° W 9.63 ch, S 39 1/4° W 3.22 ch, S 51 1/4° W 4.05 ch, S 31° W 7.55 ch to the U.S. Meander line. Thence run on U.S. Meander line N 87 1/2° E 4.68 ch, S 87 1/2° E 12.00 ch, N 69° E 11.00 ch, N 26 1/2° E 19.31 ch, N 55 1/4° E 20.00 ch, N 28 1/4° E 11.00 ch, N 57 1/4° E 3.27 ch to the place of beginning.

The above was embraced in Survey No. 5, made November 18th 1855 for Eli S. Marvin.

Run by the true Meridian. Magnetic Variation 15° 25' East. Surveyed in accordance with the Act of the Legislature concerning Swamp and Overflowed Lands, approved April 28th 1850, and the instruction of the Surveyor General.

Approved August 23rd 1859
Silas Wiley
County Surveyor
H. A. Higley Surveyor General
Recorded September 8th 1859
Silas Wiley
County Surveyor