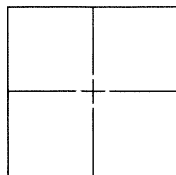

CORNER RECORDDocument Number CR 9257City of SAN LEANDROCounty of ALAMEDA, CaliforniaBrief Legal Description SAN LEANDRO BLVD. AND WEST ESTUDILLO AVE.**CORNER TYPE**Government Corner ☐ Control ☒Meander ☐ Property ☐Rancho ☐ Other ☐Date of Survey 10/11/2016**COORDINATES (Optional)**

N. _____

E. _____

Zone _____ NAD27 ☐ NAD83 ☐

NAD83 Epoch _____

Elev. _____

Vet. Datum: NGVD29 ☐ NAVD88 ☐Meas. Units: Metric ☐ Imperial ☒
Corner — Left as found ☒ Found and tagged ☐ Established ☐ Reestablished ☐ Rebuilt ☐

Identification and type of corner found: Evidence used to identify or procedure used to establish or reestablish the corner:

FOUND 1 INCH DIAMETER BRASS DISK WITH PUNCH. STAMPED 'PLS 7905' FLUSH WITH CONCRETE MEDIAN ISLAND
AT THE INTERSECTION OF SAN LEANDRO BLVD. AND WEST ESTUDILLO AVE.

A description of the physical condition of the monument as found and as set or reset: _____

SET NAIL AND TAG, STAMPED LS 8593 AS REFERENCE POINTS TO BE USED TO RESET MONUMENT SHOULD IT
BE DISTURBED DURING CONSTRUCTION ACTIVITIES.
SEE SHEET 2 FOR GRAPHIC
SURVEYOR'S STATEMENT

This Corner Record was prepared by me or under my direction in conformance with

the Land Surveyor's Act on OCTOBER 17, 20 16Signed [Signature] P.L.S. or R.S.E. No. LS # 8593**COUNTY SURVEYOR'S STATEMENT**This Corner Record was received 3 NOVEMBER, 2016 20 _____and examined and filed 20 DECEMBER, 2016 20 _____Signed Michael Ruben P.L.S. or R.S.E. No. 6843Title COUNTY SURVEYOR

County Surveyor's Comment: _____

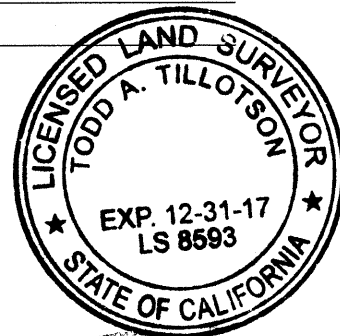
CR9252

