

CORNER RECORD

Agency Index

132/46

Document Number

CR 13729

City of EDEN TOWNSHIP

County of ALAMEDA, California

Brief Legal Description PIN MONUMENT LOCATED WITHIN THE CUL-DE-SAC OF PERLITA CT

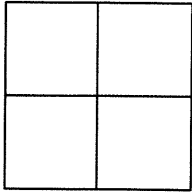

CORNER TYPE

Government Corner ☐ Control ☒
Meander ☐ Property ☐
Rancho ☐ Other ☐

Date of Survey 9/20/19

COORDINATES (Optional)

N. E.

Elevation

Units Metric ☐ U.S. Survey Foot ☐

Horizontal Datum

Zone Epoch Date

Vertical Datum

☐ Complies with Public Resources Code §§8801-8819☐ Complies with Public Resources Code §§8890-8902PLS Act Ref: ☐ 8765 (d) ☒ 8771 ☐ 8773☐ Other:

Corner/
Monument: ☒ Left as found ☐ Established ☐ Rebuilt
☐ Found and tagged ☐ Reestablished ☒ Referenced

☐ Pre-Construction☒ Post-Construction

Narrative of corner identified and monument as found, set, reset, replaced, or removed:

☐ See sheet #2 for description (s) : REF 13227

FOUND 1/8" PIN BENT IN CONCRETE IN MONUMENT WELL

FOUND AND SET POINTS AS SHOWN ON PAGE 2.

THIS POINT WAS FOUND IN AFTER A CONSTRUCTION PROJECT IN THE VICINITY.

THE TIES SHOWN HEREON ARE FOR THE PURPOSE OF PERPETUATING FOUND MONUMENTATION.
NO CLAIM IS MADE AS TO THE RELATIONSHIP OF THE POINTS OR LINES SHOWN HEREON TO TRUE
BOUNDARY LOCATION.

SURVEYOR'S STATEMENT

This Corner Record was prepared by me or under my direction in conformance with

the Professional Land Surveyors' Act on SEPTEMBER 23, 2019.

Signed Scott V. Cunha P.L.S. or R.C.E. No. LS 8525
SCOTT V. CUNHA

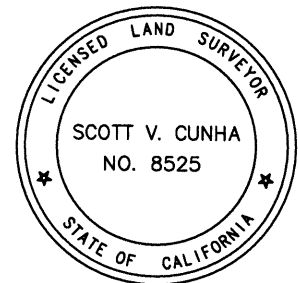

COUNTY SURVEYOR'S STATEMENT

This Corner Record was received APR 19 2020

and examined and filed APR 13 2020

Signed D. Ian Wilson P.L.S. or R.C.E. No. 7010

Title COUNTY SURVEYOR

County Surveyor's Comment

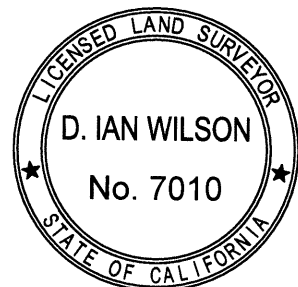

SPEC-2377-POST

SCALE: 1"=30'

LEGEND

- FOUND 1/8" PIN IN CONCRETE IN MONUMENT WELL
- ⊗ FOUND CUT CROSS IN WALK
- AA##A# ALAMEDA COUNTY MONUMENT ID
- 19592 REFERENCE STREET ADDRESS

RALSTON WAY

PERLITA CT

FOUND PIN BENT AFTER
CONSTRUCTION PROJECT IN
VICINITY.
MEASUREMENT TAKEN AT BASE
OF PIN.

2579

2603

2627

MV33Z7

2775

2751

